

GRADING NOTES

1. Site is shown on Tax Map 155F, Group C as Parcel 19.00, R.O.W.C.
2. The contractor shall check all existing and finished grades, dimensions, etc. prior to beginning work. Notify the owners representative of any discrepancies and/or errors in the plans prior to commencing work.
3. Strip and store topsoil for use in landscape areas. Stockpile on site as directed by 3. the Owners Representative. Place silt barrier at the toe of the stockpile.
4. The contractor shall comply with all pertinent O.S.H.A. provisions and the Manual of Accident Prevention and Construction, issued by the AGC of America, incorporated, and the Safety and Health Regulations of Construction issued by the U.S. Department of Labor.
5. The contractor shall conform to all local codes and perform all work in accordance with the plans specifications.
6. The contractor shall verify the location and depth of all utilities to remain. The contractor shall repair or replace any damaged utilities according to the local standards and at the contractors expense. The contractor shall call Tennessee One Call (1-800-351-1111) to locate underground utilities prior to beginning work.
7. The contractor shall provide positive drainage through the site during all phases of construction.
8. Excavated subgrades and each layer of fill material shall be of a quality acceptable to the owners representative and shall not include organic material, boulders, debris, wet material, etc. Cut or stripped areas shall be proof rolled prior to any filling. All grading activity and placement of material shall be monitored by a qualified geotechnical engineer (or their representative), or as directed by the Owners Representative. Material shall meet or exceed compaction requirements specified in the project specifications.
9. Plans are subject to revisions based on review by local governing agencies.

EROSION CONTROL NOTES

1. PHASE ONE: SITE PREPARATION
 - 1.1. Placement of the following items shall be required prior to any grading work: sediment barriers shall be placed at all toe of proposed fill areas; erosion control devices as shown on plan.
2. PHASE TWO: ROUGH GRADING
 - 2.1. The following erosion control measures shall be introduced as follows: vegetative cover to remain is to be protected and preserved as much as possible.
 - 2.2. No refuse or garbage will be disposed of on site.
 - 2.3. Placement and spreading of fill material will be started at lowest point and brought up in layers of 8" maximum.
 - 2.4. Dust control on site shall be kept within acceptable limits by sprinkling or other acceptable methods.
 - 2.5. Placement of erosion control devices as noted on the plan.
 - 2.6. Maximum cut slope cuts shall not exceed 3:1. Cut and fill slopes greater than 3:1 shall be stabilized by hydroseeding; apply Crown Vetch at a rate of 1 1/2 to 2 lbs. per 1000 square feet of surface area.
 - 2.7. Areas that have been stripped, cut slopes, fill slopes or areas otherwise disturbed shall have temporary stabilization applied after a period of 60 days.
 - 2.8. All erosion control devices and temporary stabilization measures shall be inspected H. after each rainfall. Repair or replace control devices damaged by rainfall. Restore temporary stabilization measures where washing occurs. Remove sediment from control devices where sediment exceeds one half the barrier height.
3. PHASE THREE: FINAL GRADING
 - 3.1. Topsoil shall be re-spread a minimum of 8" over all disturbed areas.
 - 3.2. Remove all sediment from sediment ponds, pipes, structures, etc. Remove temporary sediment control devices that remain.
 - 3.3. Areas that have been stripped, cut slopes, fill slopes or areas otherwise disturbed C. shall have permanent stabilization applied. Permanent stabilization shall be prior to acceptance of final grading.

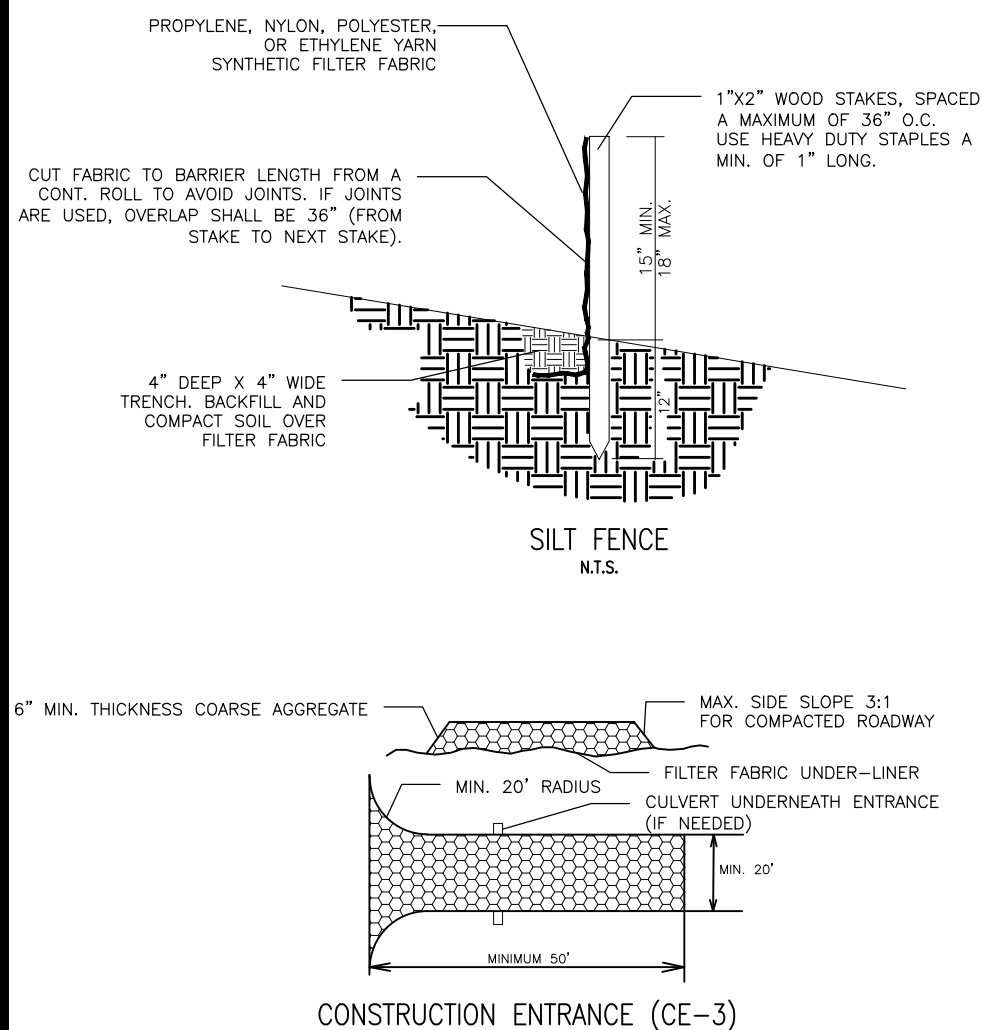

LEGEND

	EXISTING PROPERTY BOUNDARY
	EXISTING MAJOR CONTOURS
	EXISTING MINOR CONTOURS
	PROPOSED MAJOR CONTOURS
	PROPOSED MINOR CONTOURS
	PROPOSED SWALE CENTERLINE & FLOW DIRECTION
	PROPOSED SPOT ELEVATION
	PROPOSED TOP OF WALL
	PROPOSED BOTTOM OF WALL
	PROPOSED FINISH GRADE HIGH POINT

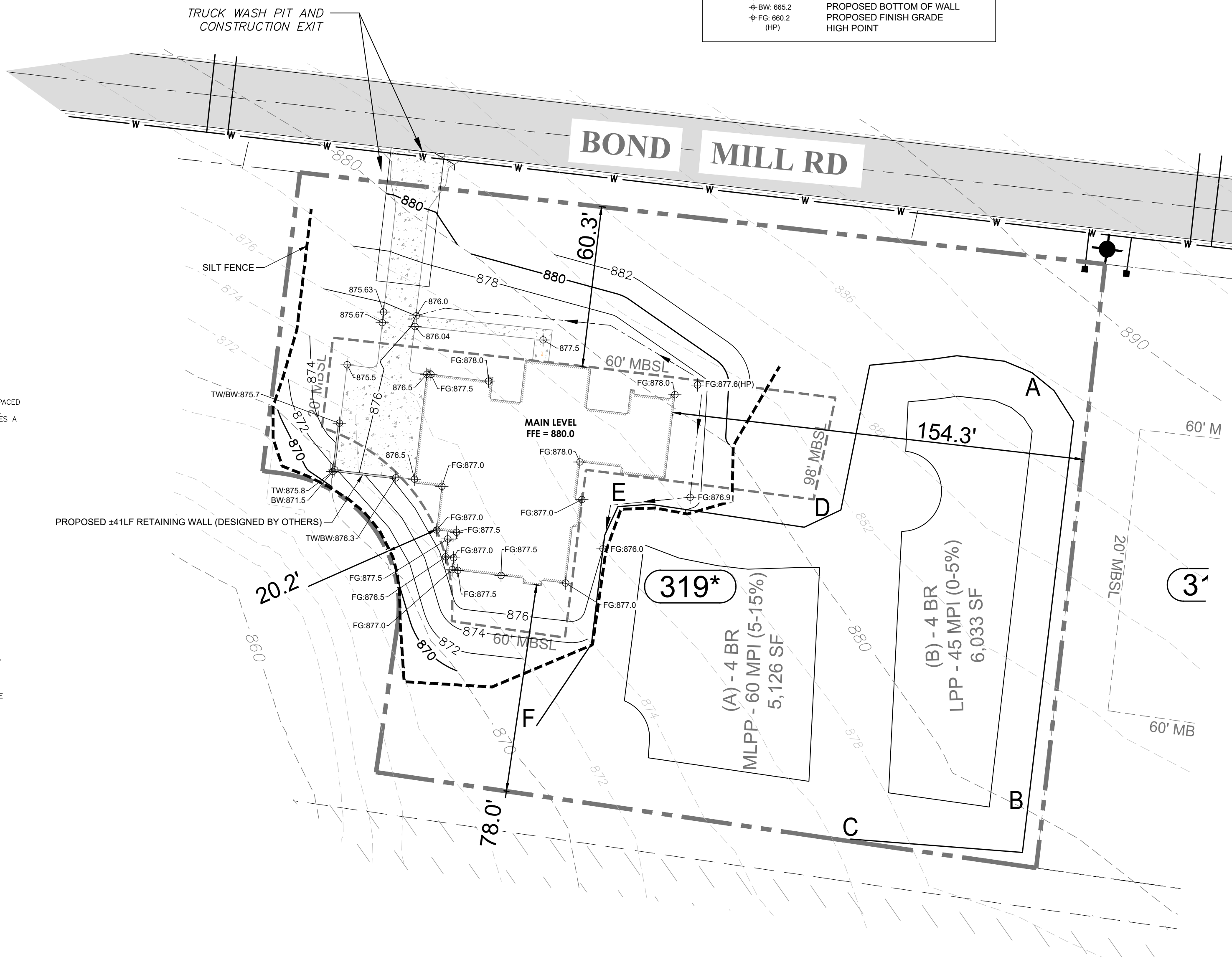
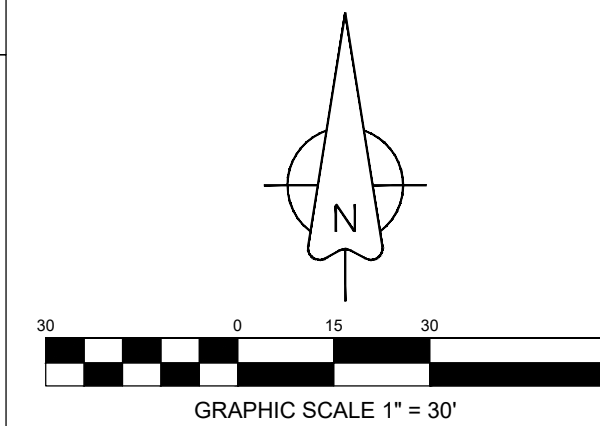

5165 BOND MILL RD
 MAP 155F, GROUP C PARCEL 19.00
 WILLIAMSON COUNTY, TENNESSEE

LOT 319 - THE MILL AT BOND SPRINGS - EROSION CONTROL SITE PLAN

NO.	DATE	REVISIONS

DATE: 05-08-2023	SCALE: 1"=50'	DRAWN BY: T-SQUARE	REVIEWER:
------------------	---------------	--------------------	-----------

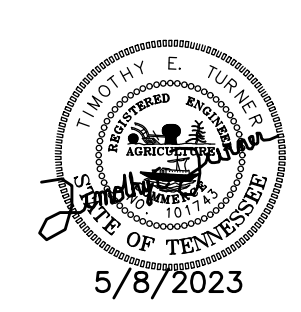

PROJECT
 22-0816

SHEET
 ECSP

